

# FAD FLAT ANGLE DRILL SERIES I

(18) NOT SHOWN

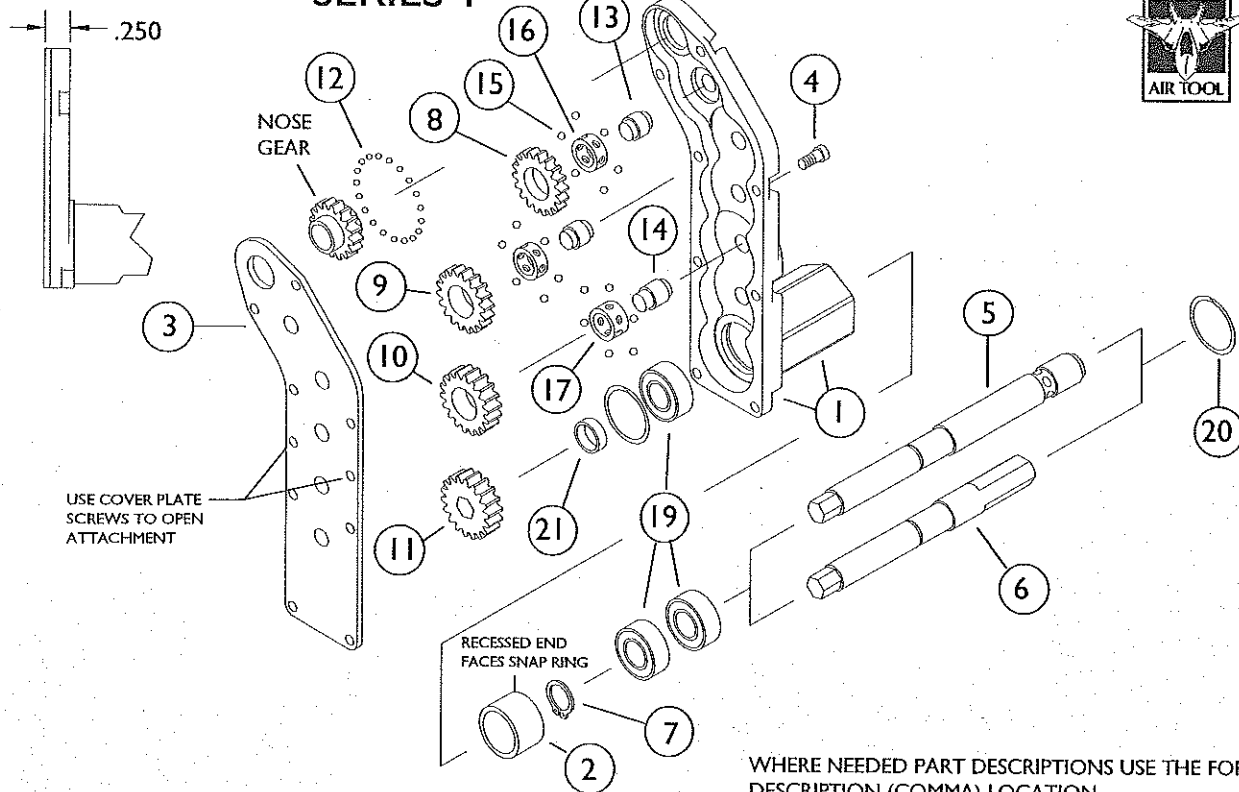

WHERE NEEDED PART DESCRIPTIONS USE THE FORMAT  
DESCRIPTION (COMMA) LOCATION.

| SERIES I NOSE GEARS |       |
|---------------------|-------|
| 1/4-28              | 14768 |
| 10-32               | 14769 |
| 9/32-40             | 14770 |
| 5/16-24             | 14771 |

## REPAIR TIPS

1) USE A SMALL AMOUNT OF GREASE ON A EXACTO KNIFE TO PICK UP BALLS

2) USE A SMALL AMOUNT OF GREASE ON PARTS TO KEEP BALLS IN PLACE

| SERIES I 14840 7 GEAR RIGHT HAND FLAT ANGLE DRILL SHORT |           |             |  |
|---|-----------|-------------|--|
| ITEM  | PART #    | QTY         | DESCRIPTION  |
| 1   | 14876     | 1           | HOUSING ASSY BARE, INCLUDES: 14783 HOUSING, 14908 TUBE |
| 2   | 14906     | 1           | SPACER, TUBE   |
| 3   | 14790     | 1           | COVER PLATE  |
| 4   | 14810     | 8           | SCREW, COVER PLATE                                     |
| 5   | 14912     | 1           | DRIVE SHAFT, BALL LOCK                                 |
| 6   | 14909     | 1           | DRIVE SHAFT, CHUCK DRIVE                               |
| 7   | 14033     | 1           | SNAP RING, DRIVE SHAFT                                 |
| 8   | 14948     | 1           | IDLER GEAR, THIN                                       |
| 9   | 14955     | 2           | IDLER GEAR MID   |
| 10  | 14226     | 2           | IDLER GEAR SERIES 2                                    |
| 11  | 14225     | 1           | DRIVE GEAR   |
|   | SEE CHART | 1           | NOSE GEAR  |
| 12  | 14956     | 28          | BALLS, NOSE GEAR .0469                                 |
| 13  | 14469     | 3           | BEARING SHAFT  |
| 14  | 14953     | 2           | BEARING SHAFT SERIES 2                                 |
| 15  | 10004     | 6 PER SHAFT | BALLS, BEARING SHAFT .0625                             |
| 16  | 14468     | 3           | BALL CAGE  |
| 17  | 14230     | 2           | BALL CAGE SERIES 2                                     |
| 18  | 3060      | 1           | GREASE FITTING   |
| 19  | 14030     | 3           | BALL BEARING, TUBE                                     |
| 20  | 14032     | 2           | SPIROLOX RING, TUBE                                    |
| 21  | 14231     | 1           | SPACER   |