

# FAD FLAT ANGLE DRILL SERIES I

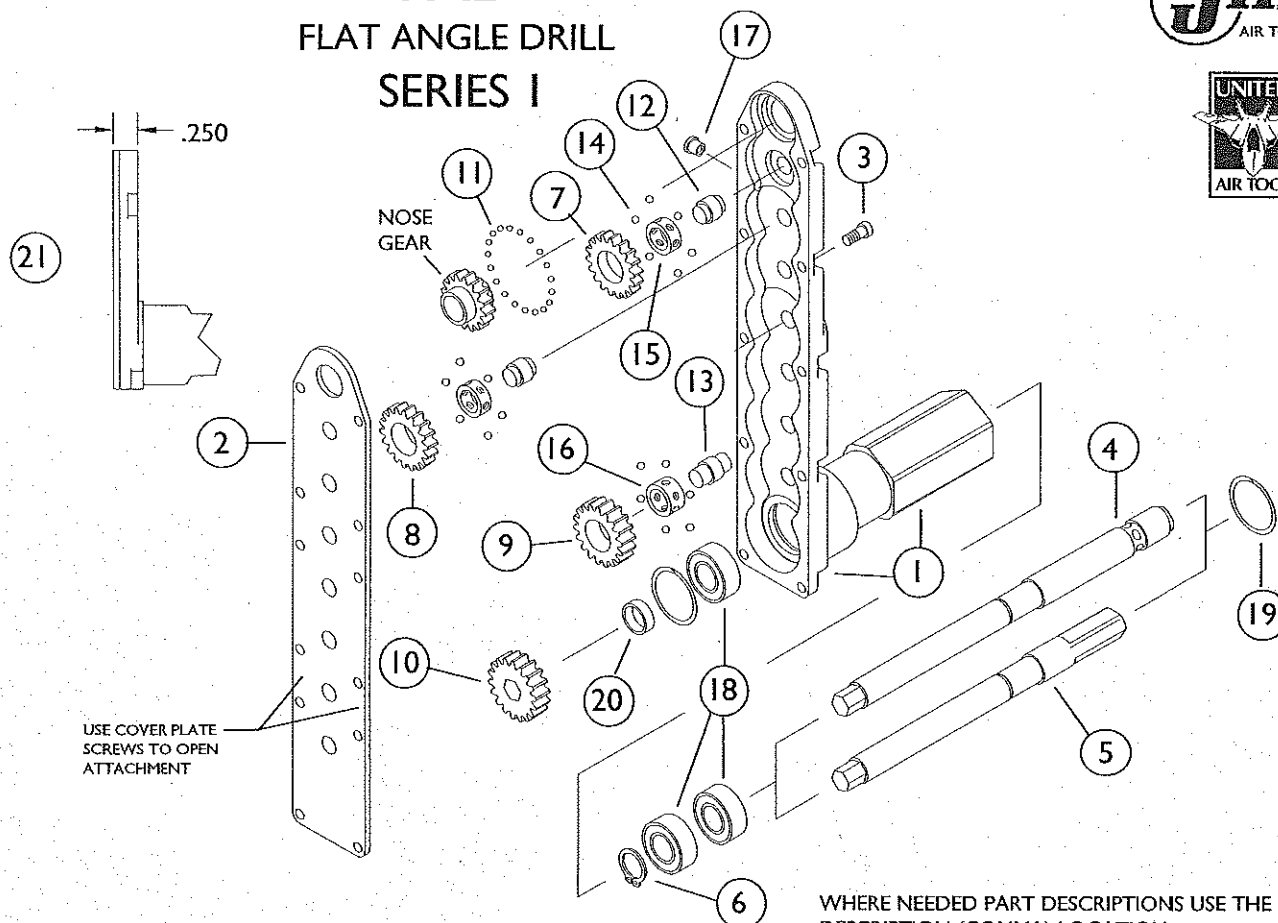

WHERE NEEDED PART DESCRIPTIONS USE THE FORMAT  
DESCRIPTION (COMMA) LOCATION.

SERIES I NOSE GEARS	
1/4-28	14768
10-32	14769
9/32-40	14770
5/16-24	14771

## REPAIR TIPS

1) USE A SMALL AMOUNT OF GREASE ON A EXACTO KNIFE TO PICK UP BALLS

2) USE A SMALL AMOUNT OF GREASE ON PARTS TO KEEP BALLS IN PLACE

SERIES I 14843 9 GEAR FLAT ANGLE DRILL EXTENDED			
ITEM	PART #	QTY	DESCRIPTION
1	14879	1	HOUSING ASSY BARE, INCLUDES: 14785 HOUSING, 14905 TUBE
2	14791	1	COVER PLATE
3	14810	10	SCREW, COVER PLATE
4	14911	1	DRIVE SHAFT, BALL LOCK
5	14910	1	DRIVE SHAFT, CHUCK DRIVE
6	14033	1	SNAP RING, DRIVE SHAFT
7	14948	1	IDLER GEAR, THIN
8	14955	2	IDLER GEAR MID
9	14226	4	IDLER GEAR SERIES 2
10	14225	1	DRIVE GEAR
	SEE CHART	1	NOSE GEAR
11	14956	28	BALLS, NOSE GEAR .0469
12	14469	3	BEARING SHAFT
13	14953	4	BEARING SHAFT SERIES 2
14	10004	6 PER SHAFT	BALLS, BEARING SHAFT .0625
15	14468	3	BALL CAGE
16	14230	4	BALL CAGE SERIES 2
17	3060	2	GREASE FITTING
18	14030	3	BALL BEARING, TUBE
19	14032	2	SPIROLOX RING, TUBE
20	14231	1	SPACER